

GENERAL LOCATION MAP ~ NOT TO SCALE

~ MAP REFERENCES ~

- #1 MAP OF SURVEY SHOWING LANDS OWNED BY RUDOLPH P. HANNA BY SPENCER J. JOHNSON, L.S., DATED MARCH 18, 1960 AND FILED IN THE ESSEX CO. CLERK'S OFFICE AS MAP No. 1692.
- #2 MAP OF SURVEY PREPARED FOR WILLIAM T. MCCUTCHEON, JR., BY KENNETH E. KRATZ, L.S., DATED SEPTEMBER 24, 1982.
- #3 MAP OF SURVEY PREPARED FOR ALPHEUS C. BEANE, JR. & LINDA M. BEANE BY KENNETH E. KRATZ, L.S., DATED SEPTEMBER 22, 1982 AND FILED IN THE ESSEX CO. CLERK'S OFFICE AS MAP No. 3175.
- #4 MAP OF SURVEY PREPARED FOR JAMES R. CARROLL, BY KENNETH E. KRATZ, L.S., DATED SEPTEMBER 24, 1982 AND FILED IN THE ESSEX CO. CLERK'S OFFICE AS MAP No. 3523.
- #5 MAP OF SURVEY OF THE KOBEL FARM PREPARED FOR CAMP DUDLEY YMCA, INC. BY KEVIN A. HALL, L.S., DATED AUGUST 4, 1997 AND FILED IN THE ESSEX CO. CLERK'S OFFICE AS MAP No. 5032.
- #6 MCCUTCHEON SUBDIVISION MAP PREPARED FOR WILLIAM T. JR., & THERESA MCCUTCHEON BY KEVIN A. HALL, L.S., DATED JULY 21, 2003 AND FILED IN THE ESSEX CO. CLERK'S OFFICE AS MAP No. 5640.
- #7 MCCUTCHEON SUBDIVISION MAP PREPARED FOR WILLIAM T. JR., & THERESA MCCUTCHEON, TRUSTEES BY KEVIN A. HALL, L.S., DATED DEC. 28, 2018 AND FILED IN THE ESSEX CO. CLERK'S OFFICE AS MAP No. 7571.
- #8 SKETCH MAP OF THE WHITE FARM SUBDIVISION PREPARED FOR DANIEL J. WHITE BY KEVIN A. HALL, L.S., DATED DECEMBER 27, 2024 REFERENCED IN APA JURISDICTIONAL DETERMINATION J2024-1168.

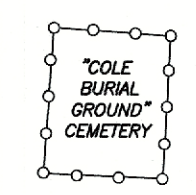

LOT 1 ~ 55.8± ACRES

1 UNUSED P.B.R.
(WEST OF ROAD)

LOT NOT SURVEYED
ACREAGE FROM TAX MAP

PART OF TM# 76.4-1-37.000

OTHER LANDS OF
DANIEL J. WHITE
BK. 2083 PG. 79 ~ MAY 11, 2022
FROM
THE WHITE FAMILY IRREVOCABLE TRUST
FORMERLY PART OF
CHARLES A. WHITE
BK. 198 PG. 130 ~ SEPTEMBER 30, 1930
FROM
BESSIE R. E. SHERMAN
HEIR OF SUSAN SHERMAN

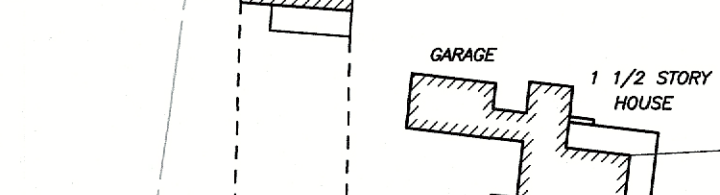

5575 NYS ROUTE 9N

300' - A.P.A. CEA LINE

CHAINS IN THIS AREA
NOT SHOWN HEREON

NEW YORK STATE ROUTES 9N & 22

FOX RUN WAY

PRIVATE ROAD

TO RPT. HWY.

TO RPT. HWY.

TO RPT. HWY.

TO RPT. HWY.

TO RPT. HWY.

TO RPT. HWY.

TO RPT. HWY.

TO RPT. HWY.

TO RPT. HWY.

TO RPT. HWY.

TO RPT. HWY.

TO RPT. HWY.

TO RPT. HWY.

N.Y.S. GRID NORTH
~1983 DATUM~

MAGNETIC NORTH 1980

12.2 MILES TO THE SOUTHERLY
INTERSECTION OF CAMP DUDLEY RD.

FOUND 1/2" IRON PIPE PLUG IN A DRILL
HOLE IN A 3' X 3' X 2' HIGH BOULDER
IN THE WEST END OF A STONEWALL
LOCATED AT THE SOUTHWEST CORNER
OF LOT 3 OF MAP No. 5032.

FOUND 2.5' HIGH 1/2" IRON ROD IN STONES.

FOUND 2.5' HIGH 1/2" IRON ROD IN STONES.

FOUND 1' HIGH 1" IRON PIPE IN STONES.

FOUND 1' HIGH 1" IRON PIPE IN STONES.

FOUND 1' HIGH 1" IRON PIPE IN STONES.

FOUND 1' HIGH 1" IRON PIPE IN STONES.

FOUND 1' HIGH 1" IRON PIPE IN STONES.

FOUND 1' HIGH 1" IRON PIPE IN STONES.

FOUND 1' HIGH 1" IRON PIPE IN STONES.

FOUND 1' HIGH 1" IRON PIPE IN STONES.

FOUND 1' HIGH 1" IRON PIPE IN STONES.

FOUND 1' HIGH 1" IRON PIPE IN STONES.

FOUND 1' HIGH 1" IRON PIPE IN STONES.

FOUND 1' HIGH 1" IRON PIPE IN STONES.

FOUND 1' HIGH 1" IRON PIPE IN STONES.

FOUND 1' HIGH 1" IRON PIPE IN STONES.

FOUND 1' HIGH 1" IRON PIPE IN STONES.

FOUND 1' HIGH 1" IRON PIPE IN STONES.

FOUND 1' HIGH 1" IRON PIPE IN STONES.

FOUND 1' HIGH 1" IRON PIPE IN STONES.

FOUND 1' HIGH 1" IRON PIPE IN STONES.

FOUND 1' HIGH 1" IRON PIPE IN STONES.

FOUND 1' HIGH 1" IRON PIPE IN STONES.

FOUND 1' HIGH 1" IRON PIPE IN STONES.

FOUND 1' HIGH 1" IRON PIPE IN STONES.

GRIDLEY ASSOCIATES, LC
BK. 1515 PG. 233 ~ NOVEMBER 1, 2006
FROM
NSHE OLDSMAR, LLC
FORMERLY
CHRISTA G. OCKER
BK. 1362 PG. 155 ~ JUNE 3, 2003
FROM
JAMES R. & GENE G. CARROLL
FORMERLY
JAMES R. & GENE G. CARROLL
BK. 952 PG. 340 ~ SEPTEMBER 29, 1989
FROM
JAMES R. CARROLL
FORMERLY
RUDOLPH P. HANNA
BK. 340 PG. 568 ~ OCTOBER 23, 1956
FROM
NELSON & ALLISON S. BEEBE

FOUND 1/2" IRON PIPE PLUG IN A DRILL
HOLE IN A 3' X 3' X 2' HIGH BOULDER
IN THE WEST END OF A STONEWALL
LOCATED AT THE SOUTHWEST CORNER
OF LOT 3 OF MAP No. 5032.

FOUND 2.5' HIGH 1/2" IRON ROD IN STONES.

FOUND 2.5' HIGH 1/2" IRON ROD IN STONES.

FOUND 1' HIGH 1" IRON PIPE IN STONES.

FOUND 1' HIGH 1" IRON PIPE IN STONES.

FOUND 1' HIGH 1" IRON PIPE IN STONES.

FOUND 1' HIGH 1" IRON PIPE IN STONES.

FOUND 1' HIGH 1" IRON PIPE IN STONES.

FOUND 1' HIGH 1" IRON PIPE IN STONES.

FOUND 1' HIGH 1" IRON PIPE IN STONES.

FOUND 1' HIGH 1" IRON PIPE IN STONES.

FOUND 1' HIGH 1" IRON PIPE IN STONES.

FOUND 1' HIGH 1" IRON PIPE IN STONES.

FOUND 1' HIGH 1" IRON PIPE IN STONES.

FOUND 1' HIGH 1" IRON PIPE IN STONES.

FOUND 1' HIGH 1" IRON PIPE IN STONES.

FOUND 1' HIGH 1" IRON PIPE IN STONES.

FOUND 1' HIGH 1" IRON PIPE IN STONES.

FOUND 1' HIGH 1" IRON PIPE IN STONES.

FOUND 1' HIGH 1" IRON PIPE IN STONES.

FOUND 1' HIGH 1" IRON PIPE IN STONES.

FOUND 1' HIGH 1" IRON PIPE IN STONES.

FOUND 1' HIGH 1" IRON PIPE IN STONES.

FOUND 1' HIGH 1" IRON PIPE IN STONES.

FOUND 1' HIGH 1" IRON PIPE IN STONES.

FOUND 1' HIGH 1" IRON PIPE IN STONES.

FOUND 1' HIGH 1" IRON PIPE IN STONES.

FOUND 1' HIGH 1" IRON PIPE IN STONES.

GRIDLEY ASSOCIATES, LC
BK. 1515 PG. 233 ~ NOVEMBER 1, 2006
FROM
NSHE OLDSMAR, LLC
FORMERLY
CHRISTA G. OCKER
BK. 1362 PG. 155 ~ JUNE 3, 2003
FROM
JAMES R. & GENE G. CARROLL
FORMERLY
JAMES R. & GENE G. CARROLL
BK. 952 PG. 340 ~ SEPTEMBER 29, 1989
FROM
JAMES R. CARROLL
FORMERLY
RUDOLPH P. HANNA
BK. 340 PG. 568 ~ OCTOBER 23, 1956
FROM
NELSON & ALLISON S. BEEBE

FOUND 1/2" IRON PIPE PLUG IN A DRILL
HOLE IN A 3' X 3' X 2' HIGH BOULDER
IN THE WEST END OF A STONEWALL
LOCATED AT THE SOUTHWEST CORNER
OF LOT 3 OF MAP No. 5032.

FOUND 2.5' HIGH 1/2" IRON ROD IN STONES.

FOUND 2.5' HIGH 1/2" IRON ROD IN STONES.

FOUND 1' HIGH 1" IRON PIPE IN STONES.

FOUND 1' HIGH 1" IRON PIPE IN STONES.

FOUND 1' HIGH 1" IRON PIPE IN STONES.

FOUND 1' HIGH 1" IRON PIPE IN STONES.

FOUND 1' HIGH 1" IRON PIPE IN STONES.

FOUND 1' HIGH 1" IRON PIPE IN STONES.

FOUND 1' HIGH 1" IRON PIPE IN STONES.

FOUND 1' HIGH 1" IRON PIPE IN STONES.

FOUND 1' HIGH 1" IRON PIPE IN STONES.

FOUND 1' HIGH 1" IRON PIPE IN STONES.

FOUND 1' HIGH 1" IRON PIPE IN STONES.

FOUND 1' HIGH 1" IRON PIPE IN STONES.

FOUND 1' HIGH 1" IRON PIPE IN STONES.

FOUND 1' HIGH 1" IRON PIPE IN STONES.

FOUND 1' HIGH 1" IRON PIPE IN STONES.

FOUND 1' HIGH 1" IRON PIPE IN STONES.

FOUND 1' HIGH 1" IRON PIPE IN STONES.

FOUND 1' HIGH 1" IRON PIPE IN STONES.

FOUND 1' HIGH 1" IRON PIPE IN STONES.

FOUND 1' HIGH 1" IRON PIPE IN STONES.

FOUND 1' HIGH 1" IRON PIPE IN STONES.

FOUND 1' HIGH 1" IRON PIPE IN STONES.

FOUND 1' HIGH 1" IRON PIPE IN STONES.

FOUND 1' HIGH 1" IRON PIPE IN STONES.

FOUND 1' HIGH 1" IRON PIPE IN STONES.

GRIDLEY ASSOCIATES, LC
BK. 1515 PG. 233 ~ NOVEMBER 1, 2006
FROM
NSHE OLDSMAR, LLC
FORMERLY
CHRISTA G. OCKER
BK. 1362 PG. 155 ~ JUNE 3, 2003
FROM
JAMES R. & GENE G. CARROLL
FORMERLY
JAMES R. & GENE G. CARROLL
BK. 952 PG. 340 ~ SEPTEMBER 29, 1989
FROM
JAMES R. CARROLL
FORMERLY
RUDOLPH P. HANNA
BK. 340 PG. 568 ~ OCTOBER 23, 1956
FROM
NELSON & ALLISON S. BEEBE

FOUND 1/2" IRON PIPE PLUG IN A DRILL
HOLE IN A 3' X 3' X 2' HIGH BOULDER
IN THE WEST END OF A STONEWALL
LOCATED AT THE SOUTHWEST CORNER
OF LOT 3 OF MAP No. 5032.

FOUND 2.5' HIGH 1/2" IRON ROD IN STONES.

FOUND 2.5' HIGH 1/2" IRON ROD IN STONES.

FOUND 1' HIGH 1" IRON PIPE IN STONES.

FOUND 1' HIGH 1" IRON PIPE IN STONES.

FOUND 1' HIGH 1" IRON PIPE IN STONES.

FOUND 1' HIGH 1" IRON PIPE IN STONES.

FOUND 1' HIGH 1" IRON PIPE IN STONES.

FOUND 1' HIGH 1" IRON PIPE IN STONES.

FOUND 1' HIGH 1" IRON PIPE IN STONES.

FOUND 1' HIGH 1" IRON PIPE IN STONES.

FOUND 1' HIGH 1" IRON PIPE IN STONES.

FOUND 1' HIGH 1" IRON PIPE IN STONES.

FOUND 1' HIGH 1" IRON PIPE IN STONES.

FOUND 1' HIGH 1" IRON PIPE IN STONES.

FOUND 1' HIGH 1" IRON PIPE IN STONES.

FOUND 1' HIGH 1" IRON PIPE IN STONES.

FOUND 1' HIGH 1" IRON PIPE IN STONES.

FOUND 1' HIGH 1" IRON PIPE IN STONES.

FOUND 1' HIGH 1" IRON PIPE IN STONES.

FOUND 1' HIGH 1" IRON PIPE IN STONES.

FOUND 1' HIGH 1" IRON PIPE IN STONES.

FOUND 1' HIGH 1" IRON PIPE IN STONES.

FOUND 1' HIGH 1" IRON PIPE IN STONES.

FOUND 1' HIGH 1" IRON PIPE IN STONES.

FOUND 1' HIGH 1" IRON PIPE IN STONES.

FOUND 1' HIGH 1" IRON PIPE IN STONES.

FOUND 1' HIGH 1" IRON PIPE IN STONES.

GRIDLEY ASSOCIATES, LC
BK. 1515 PG. 233 ~ NOVEMBER 1, 2006
FROM
NSHE OLDSMAR, LLC
FORMERLY
CHRISTA G. OCKER
BK. 1362 PG. 155 ~ JUNE 3, 2003
FROM
JAMES R. & GENE G. CARROLL
FORMERLY
JAMES R. & GENE G. CARROLL
BK. 952 PG. 340 ~ SEPTEMBER 29, 1989
FROM
JAMES R. CARROLL
FORMERLY
RUDOLPH P. HANNA
BK. 340 PG. 568 ~ OCTOBER 23, 1956
FROM
NELSON & ALLISON S. BEEBE

FOUND 1/2" IRON PIPE PLUG IN A DRILL
HOLE IN A 3' X 3' X 2' HIGH BOULDER
IN THE WEST END OF A STONEWALL
LOCATED AT THE SOUTHWEST CORNER
OF LOT 3 OF MAP No. 5032.

FOUND 2.5' HIGH 1/2" IRON ROD IN STONES.

FOUND 2.5' HIGH 1/2" IRON ROD IN STONES.

FOUND 1' HIGH 1" IRON PIPE IN STONES.

FOUND 1' HIGH 1" IRON PIPE IN STONES.

FOUND 1' HIGH 1" IRON PIPE IN STONES.

FOUND 1' HIGH 1" IRON PIPE IN STONES.

FOUND 1' HIGH 1" IRON PIPE IN STONES.

FOUND 1' HIGH 1" IRON PIPE IN STONES.

FOUND 1' HIGH 1" IRON PIPE IN STONES.

FOUND 1' HIGH 1" IRON PIPE IN STONES.

FOUND 1' HIGH 1" IRON PIPE IN STONES.

FOUND 1' HIGH 1" IRON PIPE IN STONES.

FOUND 1' HIGH 1" IRON PIPE IN STONES.

FOUND 1' HIGH 1" IRON PIPE IN STONES.

FOUND 1' HIGH 1" IRON PIPE IN STONES.

FOUND 1' HIGH 1" IRON PIPE IN STONES.

FOUND 1' HIGH 1" IRON PIPE IN STONES.

FOUND 1' HIGH 1" IRON PIPE IN STONES.

FOUND 1' HIGH 1" IRON PIPE IN STONES.

FOUND 1' HIGH 1" IRON PIPE IN STONES.

FOUND 1' HIGH 1" IRON PIPE IN STONES.

FOUND 1' HIGH 1" IRON PIPE IN STONES.

FOUND 1' HIGH 1" IRON PIPE IN STONES.

FOUND 1' HIGH 1" IRON PIPE IN STONES.

FOUND 1' HIGH 1" IRON PIPE IN STONES.

FOUND 1' HIGH 1" IRON PIPE IN STONES.

FOUND 1' HIGH 1" IRON PIPE IN STONES.

GRIDLEY ASSOCIATES, LC
BK. 1515 PG. 233 ~ NOVEMBER 1, 2006
FROM
NSHE OLDSMAR, LLC
FORMERLY
CHRISTA G. OCKER
BK. 1362 PG. 155 ~ JUNE 3, 2003
FROM
JAMES R. & GENE G. CARROLL
FORMERLY
JAMES R. & GENE G. CARROLL
BK. 952 PG. 340 ~ SEPTEMBER 29, 1989
FROM
JAMES R. CARROLL
FORMERLY
RUDOLPH P. HANNA
BK. 340 PG. 568 ~ OCTOBER 23, 1956
FROM
NELSON & ALLISON S. BEEBE

FOUND 1/2" IRON PIPE PLUG IN A DRILL
HOLE IN A 3' X 3' X 2' HIGH BOULDER
IN THE WEST END OF A STONEWALL
LOCATED AT THE SOUTHWEST CORNER
OF LOT 3 OF MAP No. 5032.

FOUND 2.5' HIGH 1/2" IRON ROD IN STONES.

FOUND 2.5' HIGH 1/2" IRON ROD IN STONES.

FOUND 1' HIGH 1" IRON PIPE IN STONES.

FOUND 1' HIGH 1" IRON PIPE IN STONES.

FOUND 1' HIGH 1" IRON PIPE IN STONES.

FOUND 1' HIGH 1" IRON PIPE IN STONES.

FOUND 1' HIGH 1" IRON PIPE IN STONES.

FOUND 1' HIGH 1" IRON PIPE IN STONES.

FOUND 1' HIGH 1" IRON PIPE IN STONES.

FOUND 1' HIGH 1" IRON PIPE IN STONES.

FOUND 1' HIGH 1" IRON PIPE IN STONES.

FOUND 1' HIGH 1" IRON PIPE IN STONES.

FOUND 1' HIGH 1" IRON PIPE IN STONES.

FOUND 1' HIGH 1" IRON PIPE IN STONES.

FOUND 1' HIGH 1" IRON PIPE IN STONES.

FOUND 1' HIGH 1" IRON PIPE IN STONES.

FOUND 1' HIGH 1" IRON PIPE IN STONES.

FOUND 1' HIGH 1" IRON PIPE IN STONES.

FOUND 1' HIGH 1" IRON PIPE IN STONES.

FOUND 1' HIGH 1" IRON PIPE IN STONES.

FOUND 1' HIGH 1" IRON PIPE IN STONES.

FOUND 1' HIGH 1" IRON PIPE IN STONES.

FOUND 1' HIGH 1" IRON PIPE IN STONES.

FOUND 1' HIGH 1" IRON PIPE IN STONES.

FOUND 1' HIGH 1" IRON PIPE IN STONES.

FOUND 1' HIGH 1" IRON PIPE IN STONES.

FOUND 1' HIGH 1" IRON PIPE IN STONES.

GRIDLEY ASSOCIATES, LC
BK. 1515 PG. 233 ~ NOVEMBER 1, 2006
FROM
NSHE OLDSMAR, LLC
FORMERLY
CHRISTA G. OCKER
BK. 1362 PG. 155 ~ JUNE 3, 2003
FROM
JAMES R. & GENE G. CARROLL
FORMERLY
JAMES R. & GENE G. CARROLL
BK. 952 PG. 340 ~ SEPTEMBER 29, 1989
FROM
JAMES R. CARROLL
FORMERLY
RUDOLPH P. HANNA
BK. 340 PG. 568 ~ OCTOBER 23, 1956
FROM
NELSON & ALLISON S. BEEBE

FOUND 1/2" IRON PIPE PLUG IN A DRILL
HOLE IN A 3' X 3' X 2' HIGH BOULDER
IN THE WEST END OF A STONEWALL
LOCATED AT THE SOUTHWEST CORNER
OF LOT 3 OF MAP No. 5032.

FOUND 2.5' HIGH 1/2" IRON ROD IN STONES.

FOUND 2.5' HIGH 1/2" IRON ROD IN STONES.

FOUND 1' HIGH 1" IRON PIPE IN STONES.

FOUND 1' HIGH 1" IRON PIPE IN STONES.

FOUND 1' HIGH 1" IRON PIPE IN STONES.

FOUND 1' HIGH 1" IRON PIPE IN STONES.

FOUND 1' HIGH 1" IRON PIPE IN STONES.

FOUND 1' HIGH 1" IRON PIPE IN STONES.